

DOME MATERIAL

POLYCARBONATE DOME(S) = .118" Thick
 (Choose Polycarbonate for excellent impact resistance
 This is our standard material used)

IMPACT MODIFIED ACRYLIC DOME(S) = .187" Thick
 (Choose 100% Impact Modified Acrylic for excellent impact
 resistance and for larger domes where thicker material is required)

COLOR & TINT OPTIONS

	Approx Light Transmission	
	IM Acrylic	Polycarb
CLEAR/ CLEAR	85%	85%
CLEAR/ BRONZE	24%	25%
BRONZE/ BRONZE	7%	7%
CLEAR/ STANDARD WHITE	47%	23%
STANDARD WHITE/ CLEAR	47%	23%
CLEAR/ HIGH LIGHT TRANS WHITE	N/A	68%
HIGH LIGHT TRANS WHITE/ CLEAR	N/A	68%
CLEAR/ LIGHT GRAY	N/A	50%
CLEAR/ DARK GRAY	N/A	25%
OTHER:		

PYRAMID PITCH - Degrees

22 DEGREES 30 DEGREES 40 DEGREES
 SPECIAL PITCH (Degrees/ Height)

QTY =

DIM. #1 = X

DIM. #2 (flange) =

DIM. #3 (height) =



REPLACEMENT PYRAMID DOME CHECKLIST: DOUBLE DOUBLE PYRAMID DOMES

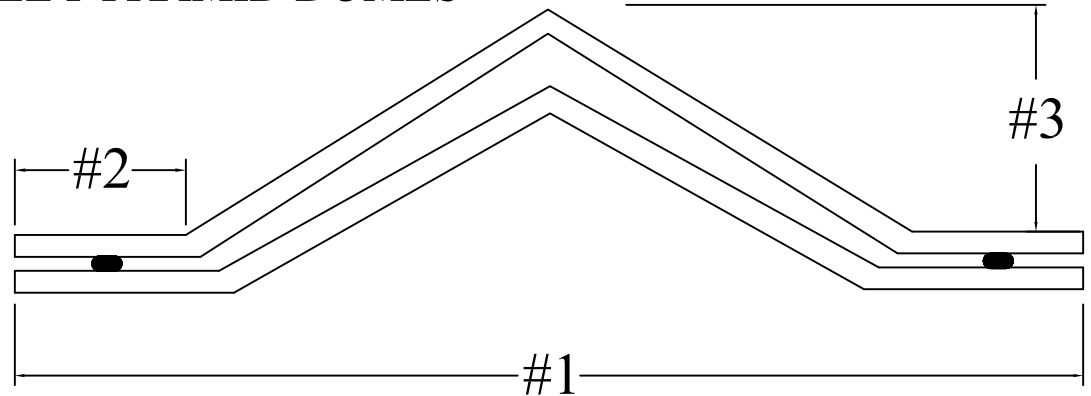

Width X Length is Required

The above shape is the only option available. If there is a 90 degree bend where the flange (dim #2) intersects the dome rise, our replacement domes will not fit your frame. It is the purchasers responsibility to confirm shape and compatibility with the existing frame.

Sealant tape for use between the domes is included and provided loose unless noted otherwise on your sales order. Please refer to the installation instructions for proper application of the sealant tape.

Replacement Pyramid Domes are formed pieces of plastic and no sealant, fasteners or gaskets of any kind are included.

The flange(s) of replacement dome(s) or pyramid(s) will have a visible lack of uniformity or flatness and appear as a "wave". This is normal, unavoidable and will flatten upon proper installation in the existing frame.

Approved By:

Date: