

DESIGN PRESSURE = +60psf / -100psf

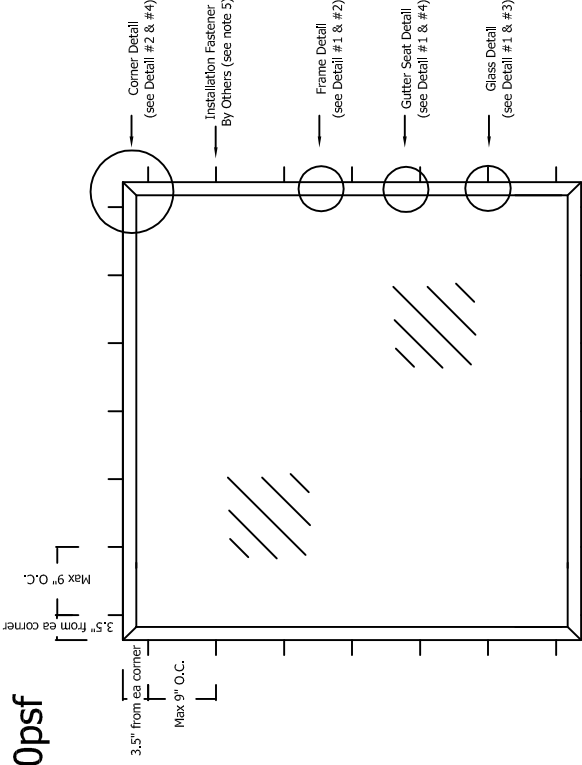
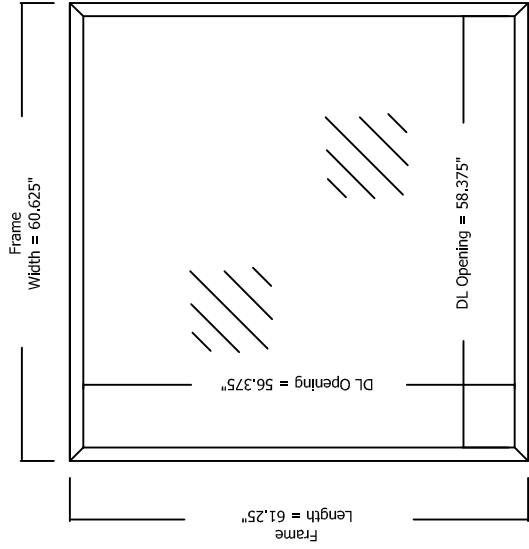

Notes:

- This skylight is designed to comply with all zones, including the HVHZ, of the Florida Building Code and all zones of the designated catastrophe area of the Texas Gulf Coast.
- This skylight meets small & large missile impact resistance (TAS-201/ASTM E1886/ASTM E1996) and no other protection is required.
- All framing and roof deck is by others and must comply with the Florida Building Code or the designated catastrophe area of the Texas Gulf Coast.
- All sizes equal to or less than the test size total square footage are to be accepted under this NOA.
- Fasteners used to attach skylight to wood curb are to be minimum #12 X 1.5" stainless steel with minimum embedment of 1.25"

Bill of Materials:

- 6063-T5 Extruded Aluminum Frame mitered and welded at four corners. Manufacturer - Maxim
- 6063-T5 Extruded Aluminum Gutter mitered and welded at four corners. Manufacturer - Maxim
- Dow Corning 795 Silicone Building Sealant located between aluminum frame and glass (glass bite) and glass and gutter. Manufacturer - Dow Corning
- 7/8" Insulated glass with Sentry Glass Plus interlayer: 1/8" Tempered - 3/8" stainless steel desiccant filled tube (air space) - 2 pcs 1/8" annealed with .090" Sentry Glass Plus interlayer. Manufacturer - DuPont
- #12 X 1.5" Stainless steel fasteners 3.5" from each corner, maximum 9" on center with minimum embedment of 1.25"

- Dow Corning 795 Silicone Building Sealant, Glass bite = 1.75"
- 7/8" Insulated Glass: 1/8" Tempered - 3/8" air space w/ desiccant filled stainless steel spacer - Laminated Glass (1/8" annealed glass - .090" Sentry Glass® Plus Interlayer - 1/8" annealed glass)
- Dow Corning 795 Silicone Building Sealant
- Curb Buck, Insulation & Flashing: SFP 2 X 6 with 3/8" thick white finished PVC Insulation; Fully adhered and mechanically fastened to roof deck with MAXIM OPTIONAL ACCESSORY BY MAXIM
- * Minimum distance = 4" from aluminum frame to roof surface for shingles or BUR without insulation. For insulation and roof tile add insulation or roof tile thickness to the add minimum height

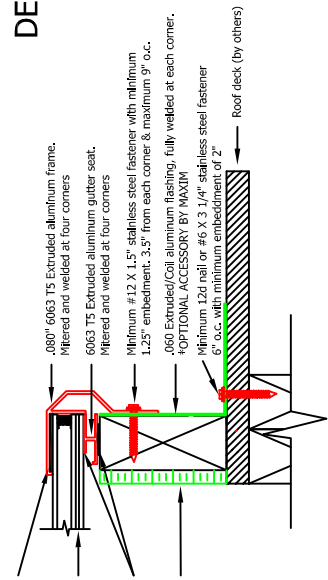

DESIGN PRESSURE = +60psf / -100psf

Inside Skylight Dimension (rough opening) Required

Qty: _____

Dimension: _____

- Impact Glass:**
- Bronze Tint:
 - Gray Tint:
 - Clear (no tint):
 - LoE366 (LoE Cubed):
 - Argon Gas Fill:

- Frame Finish:**
- Bronze Anodized:
 - Mill:
 - White Powder Coat:
 - Custom Powder Coat:

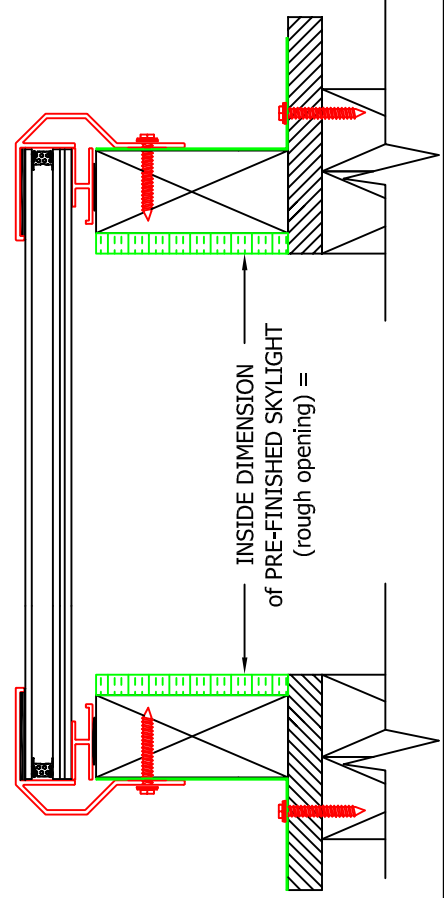

1630 Terre Colony Court Dallas, Texas 75212
 P: 888.222.4898 P: 214.905.2021 F: 214.905.2024
 www.maximskylights.com

Test Methods Include:

- ASTM E283 & TAS 202 Air Infiltration
- ASTM E331 & E547 & TAS 202 Water Infiltration
- ASTM E330 & TAS 202 Uniform Static Load
- ASTM E1886/ E1996 & TAS 201 Large & Small Missile
- ASTM E1996 & TAS 203 Cyclic Load

Test Condition

Test Condition	Result
1.57 psf & 6.24 psf	Pass
9.00 psf	Pass
+120 psf/-200 psf	DP = +60 psf/-100 psf
9lb 2 X 4 @ 50 +/- fps	No Penetration
+120 psf/-200 psf	DP = +60 psf/-100 psf

Tested and conforming to AAMA/WDMA/CSA 101/1.S.2/A440 & ASTM E1300